

Cable Termination Accessories

Copper Lugs

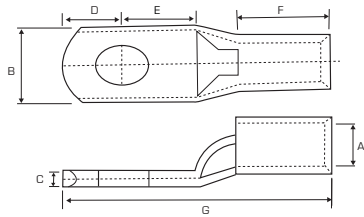

| Part No. Standard | Part No. Bellmouth | Nom Cond. | Stud Size | DIMENSION AUSTRALIAN TYPE | | | | | | |
|----------------------|-----------------------|--------------|--------------|---------------------------|------|-----|----|----|-----|------|
| | | | | A | B | C | D | E | F | G |
| KL1.5-4 | KL1.5-4BM | 1.5 | 4 | 2 | 8 | 1 | 4 | 5 | 7.5 | 18.5 |
| KL1.5-5 | KL1.5-5BM | 1.5 | 5 | 2 | 8 | 1 | 4 | 5 | 7.5 | 18.5 |
| KL1.5-6 | KL1.5-6BM | 1.5 | 6 | 2 | 10 | 0.8 | 4 | 6 | 7.5 | 19.5 |
| KL2.5-4 | KL2.5-4BM | 2.5 | 4 | 2.5 | 8 | 1 | 4 | 5 | 8 | 19 |
| KL2.5-5 | KL2.5-5BM | 2.5 | 5 | 2.5 | 10 | 0.8 | 5 | 6 | 8 | 20 |
| KL2.5-6 | KL2.5-6BM | 2.5 | 6 | 2.5 | 10 | 0.8 | 5 | 6 | 8 | 20 |
| KL2.5-8 | KL2.5-8BM | 2.5 | 8 | 2.5 | 11 | 0.7 | 6 | 9 | 8 | 26 |
| KL4-5 | KL4-5BM | 4 | 5 | 3.3 | 10 | 1 | 5 | 6 | 9 | 22 |
| KL4-6 | KL4-6BM | 4 | 6 | 3.3 | 10 | 1 | 5 | 6 | 9 | 22 |
| KL4-8 | KL4-8BM | 4 | 8 | 3.3 | 12 | 0.8 | 6 | 9 | 9 | 26 |
| KL4-10 | KL4-10BM | 4 | 10 | 3.3 | 15 | 0.8 | 8 | 11 | 9 | 32 |
| KL6-5 | KL6-5BM | 6 | 5 | 3.8 | 10 | 1.2 | 5 | 6 | 10 | 23 |
| KL6-6 | KL6-6BM | 6 | 6 | 3.8 | 12 | 1 | 6 | 9 | 10 | 27 |
| KL6-8 | KL6-8BM | 6 | 8 | 3.8 | 12 | 1 | 6 | 9 | 10 | 27 |
| KL6-10 | KL6-10BM | 6 | 10 | 3.8 | 15 | 0.8 | 8 | 11 | 10 | 32 |
| KL10-5 | KL10-5BM | 10 | 5 | 4.7 | 12 | 1.8 | 6 | 7 | 10 | 27 |
| KL10-6 | KL10-6BM | 10 | 6 | 4.7 | 12 | 1.8 | 6 | 7 | 10 | 27 |
| KL10-8 | KL10-8BM | 10 | 8 | 4.7 | 14 | 1.6 | 7 | 8 | 10 | 29 |
| KL10-10 | KL10-10BM | 10 | 10 | 4.7 | 15 | 1.5 | 8 | 10 | 10 | 32 |
| KL10-12 | KL10-12BM | 10 | 12 | 4.7 | 18 | 1 | 10 | 12 | 10 | 38 |
| KL16-6 | KL16-6BM | 16 | 6 | 5.5 | 11 | 2.4 | 7 | 9 | 19 | 39 |
| KL16-8 | KL16-8BM | 16 | 8 | 5.5 | 14 | 1.7 | 7 | 9 | 19 | 39 |
| KL16-10 | KL16-10BM | 16 | 10 | 5.5 | 16 | 1.5 | 8 | 10 | 19 | 41 |
| KL16-12 | KL16-12BM | 16 | 12 | 5.5 | 18 | 1.2 | 10 | 13 | 19 | 46 |
| KL25-6 | KL25-6BM | 25 | 6 | 7.1 | 13.5 | 2.4 | 7 | 9 | 21 | 41 |
| KL25-8 | KL25-8BM | 25 | 8 | 7.1 | 13.5 | 2.4 | 7 | 9 | 21 | 41 |
| KL25-10 | KL25-10BM | 25 | 10 | 7.1 | 16 | 1.9 | 9 | 10 | 21 | 44 |
| KL25-12 | KL25-12BM | 25 | 12 | 7.1 | 18 | 1.6 | 10 | 13 | 21 | 48 |
| KL35-6 | KL35-6BM | 35 | 6 | 8.4 | 16 | 3 | 9 | 10 | 21 | 45 |
| KL35-8 | KL35-8BM | 35 | 8 | 8.4 | 16 | 3 | 9 | 10 | 21 | 45 |
| KL35-10 | KL35-10BM | 35 | 10 | 8.4 | 18.5 | 2.6 | 9 | 10 | 21 | 45 |
| KL35-12 | KL35-12BM | 35 | 12 | 8.4 | 20 | 2.2 | 11 | 13 | 22 | 51 |
| KL50-6 | KL50-6BM | 50 | 6 | 9.5 | 18 | 3.3 | 8 | 10 | 22 | 46 |
| KL50-8 | KL50-8BM | 50 | 8 | 9.5 | 18 | 3.3 | 8 | 10 | 22 | 46 |
| KL50-10 | KL50-10BM | 50 | 10 | 9.5 | 18 | 3.3 | 8 | 10 | 22 | 46 |
| KL50-12 | KL50-12BM | 50 | 12 | 9.5 | 21 | 2.7 | 11 | 13 | 22 | 52 |
| KL70-6 | KL70-6BM | 70 | 6 | 11.3 | 21 | 3.5 | 11 | 13 | 24 | 54 |
| KL70-8 | KL70-8BM | 70 | 8 | 11.3 | 21 | 3.5 | 11 | 13 | 24 | 54 |
| KL70-10 | KL70-10BM | 70 | 10 | 11.3 | 21 | 3.5 | 11 | 13 | 24 | 54 |
| KL70-12 | KL70-12BM | 70 | 12 | 11.3 | 21 | 3.5 | 11 | 13 | 24 | 54 |
| KL70-16 | KL70-16BM | 70 | 16 | 11.3 | 26 | 3 | 14 | 16 | 24 | 61 |
| KL95-8 | KL95-8BM | 95 | 8 | 13.5 | 25 | 4 | 12 | 14 | 27 | 60 |
| KL95-10 | KL95-10BM | 95 | 10 | 13.5 | 25 | 4 | 12 | 14 | 27 | 60 |
| KL95-12 | KL95-12BM | 95 | 12 | 13.5 | 25 | 4 | 12 | 14 | 27 | 60 |

Cable Termination Accessories

Copper Lugs

| Part No. Standard | Part No. Bellmouth | Nom Cond. | Stud Size | DIMENSION AUSTRALIAN TYPE | | | | | | |
|----------------------|-----------------------|--------------|--------------|---------------------------|------|-----|----|----|----|-----|
| | | | | A | B | C | D | E | F | G |
| KL95-16 | KL95-16BM | 95 | 16 | 13.5 | 25 | 3.5 | 14 | 16 | 27 | 61 |
| KL120-8 | KL120-8BM | 120 | 8 | 15.6 | 30 | 5 | 12 | 14 | 30 | 64 |
| KL120-10 | KL120-10BM | 120 | 10 | 15.6 | 30 | 5 | 12 | 14 | 30 | 64 |
| KL120-12 | KL120-12BM | 120 | 12 | 15.6 | 30 | 5 | 12 | 14 | 30 | 64 |
| KL120-16 | KL120-16BM | 120 | 16 | 15.6 | 30 | 5 | 16 | 16 | 30 | 72 |
| KL150-10 | KL150-10BM | 150 | 10 | 16.7 | 32 | 5.8 | 16 | 16 | 30 | 71 |
| KL150-12 | KL150-12BM | 150 | 12 | 16.7 | 32 | 5.8 | 18 | 18 | 30 | 75 |
| KL150-16 | KL150-16BM | 150 | 16 | 16.7 | 32 | 5.8 | 18 | 18 | 30 | 75 |
| KL185-10 | KL185-10BM | 185 | 10 | 18.4 | 36 | 5.8 | 16 | 16 | 32 | 74 |
| KL185-12 | KL185-12BM | 185 | 12 | 18.4 | 36 | 5.8 | 18 | 18 | 32 | 79 |
| KL185-16 | KL185-16BM | 185 | 16 | 18.4 | 36 | 5.8 | 18 | 18 | 32 | 79 |
| KL240 | KL240BM | 240 | - | 21.2 | 41 | 7 | 21 | 21 | 38 | 92 |
| KL240-10 | KL240-10BM | 240 | 10 | 21.2 | 41 | 7 | 21 | 21 | 38 | 92 |
| KL240-12 | KL240-12BM | 240 | 12 | 21.2 | 41 | 7 | 21 | 21 | 38 | 92 |
| KL240-16 | KL240-16BM | 240 | 16 | 21.2 | 41 | 7 | 21 | 21 | 38 | 92 |
| KL300 | KL300BM | 300 | - | 23.8 | 46 | 7.8 | 23 | 23 | 42 | 101 |
| KL300-12 | KL300-12BM | 300 | 12 | 23.8 | 46 | 7.8 | 23 | 23 | 42 | 101 |
| KL300-16 | KL300-16BM | 300 | 16 | 23.8 | 46 | 7.8 | 23 | 23 | 42 | 101 |
| KL400 | KL400BM | 400 | - | 26.8 | 50 | 8 | 24 | 24 | 44 | 107 |
| KL500 | KL500BM | 500 | - | 30 | 56 | 9 | 27 | 27 | 50 | 119 |
| KL630 | KL630BM | 630 | - | 34 | 64.4 | 11 | 32 | 32 | 58 | 139 |

Copper Crimp Links

| Part No. | Nom Cond. | Overall Length | I.D. |
|----------|-----------|----------------|------|
| KC2.5 | 2.5 | 22.2 | 2.5 |
| KC4 | 4 | 22.2 | 3.3 |
| KC6 | 6 | 22.2 | 3.7 |
| KC10 | 10 | 22.2 | 4.7 |
| KC16 | 16 | 44.4 | 5.5 |
| KC25 | 25 | 47.6 | 7.1 |
| KC35 | 35 | 47.6 | 8.4 |
| KC50 | 50 | 47.6 | 9.5 |
| KC70 | 70 | 50.8 | 11 |
| KC95 | 95 | 54 | 13.4 |
| KC120 | 120 | 65.1 | 15.5 |
| KC150 | 150 | 65.1 | 16.3 |
| KC185 | 185 | 65.1 | 18.4 |
| KC240 | 240 | 88.9 | 21.2 |
| KC300 | 300 | 88.9 | 23.8 |
| KC400 | 400 | 88.9 | 26.8 |
| KC500 | 500 | 114.3 | 30 |
| KC630 | 630 | 114.3 | 33.5 |

